

SECTION A-A

STAIRS ARE TO BE CONSTRUCTED IN ACCORDANCE WITH THE INTERNATIONAL BUILDING CODE.

- ◆ C.I.P. CONCRETE CHEEKWALL TO FOLLOW PROFILE OF STAIR
- ◆ C.I.P. CONCRETE STAIR
- ◆ CONCRETE WALK
- ◆ GALVANIZED STEEL HANDRAILS - 1 1/2" DIA SCHEDULE 10 STEEL HANDRAILS AND POSTS, WELD ALL CONNECTIONS AND GRIND SMOOTH, SHOP PRIME AND PAINT COLOR SELECTED BY OWNER OR ARCHITECT
- ◆ COMPACTED #53 AGGREGATE 4" THICKNESS UNDER ALL STAIRS, LANDINGS, AND WALKS. NOT SHOWN IN ALL LOCATIONS FOR CLARITY.

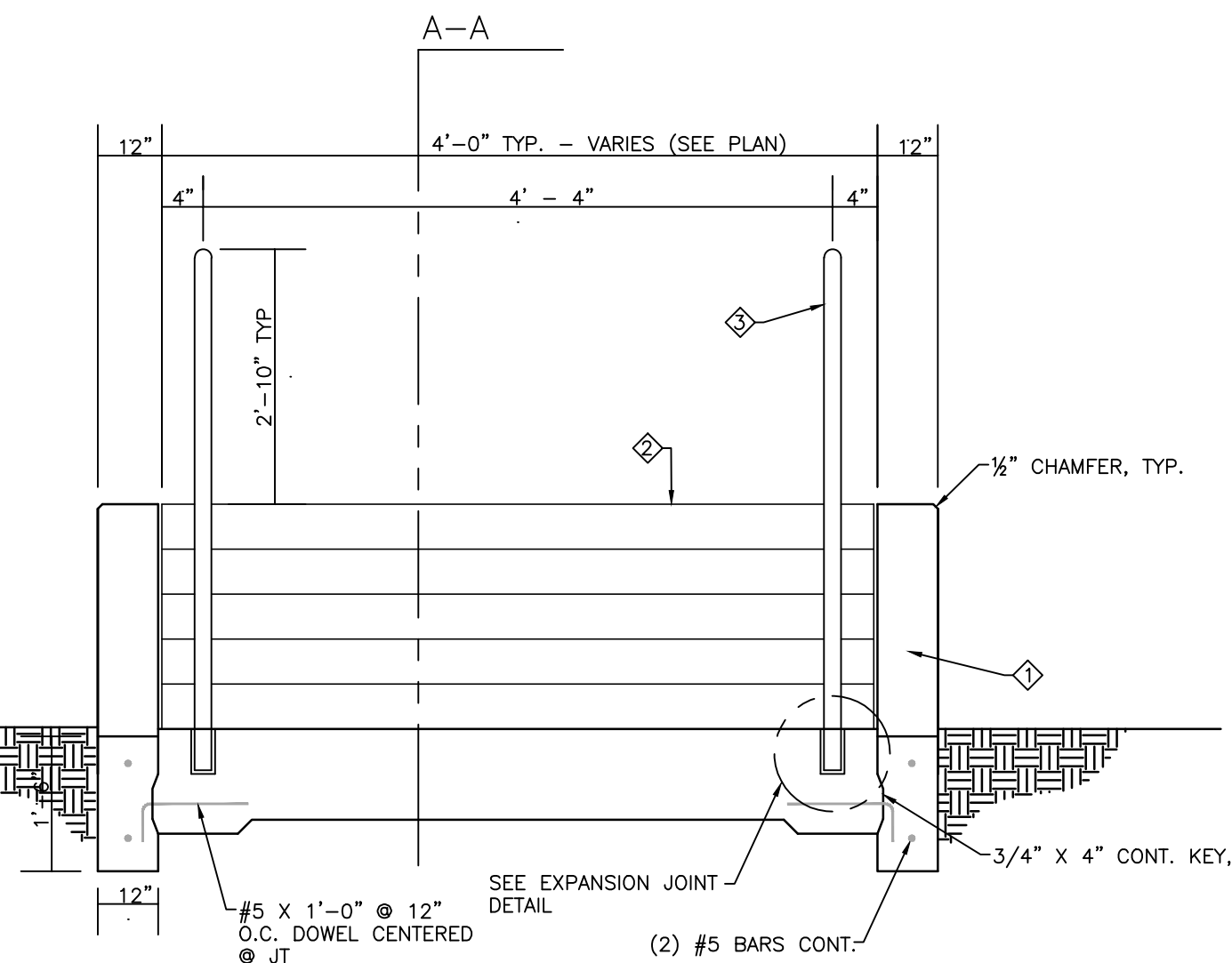

SECTION B-B

- ◆ C.I.P. CONCRETE CHEEKWALL TO MATCH PROFILE OF STAIRS
- ◆ C.I.P. CONCRETE STAIRS
- ◆ GALVANIZED STEEL HANDRAIL - SEE SECTION A-A (SHOP PRIME AND PAINTED - COLOR BY OWNER OR ARCHITECT)

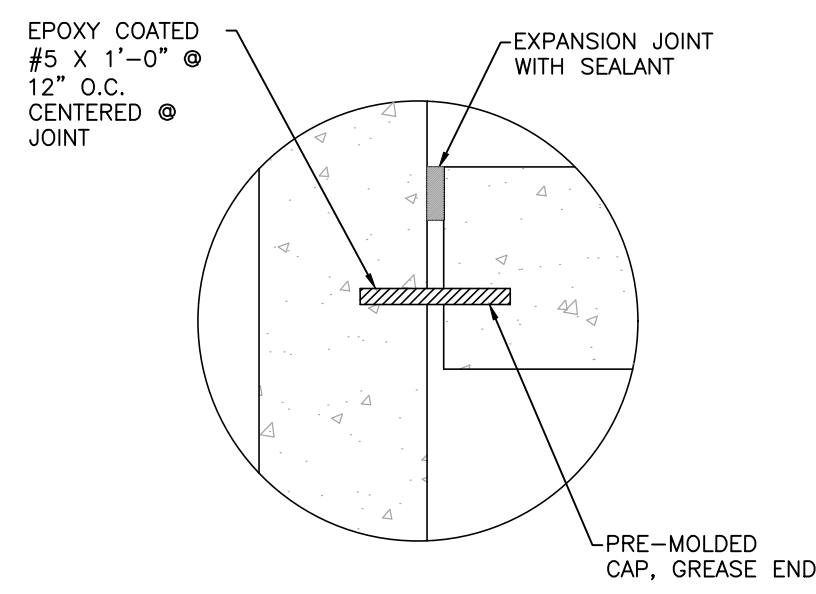

EXPANSION JOINT DETAIL

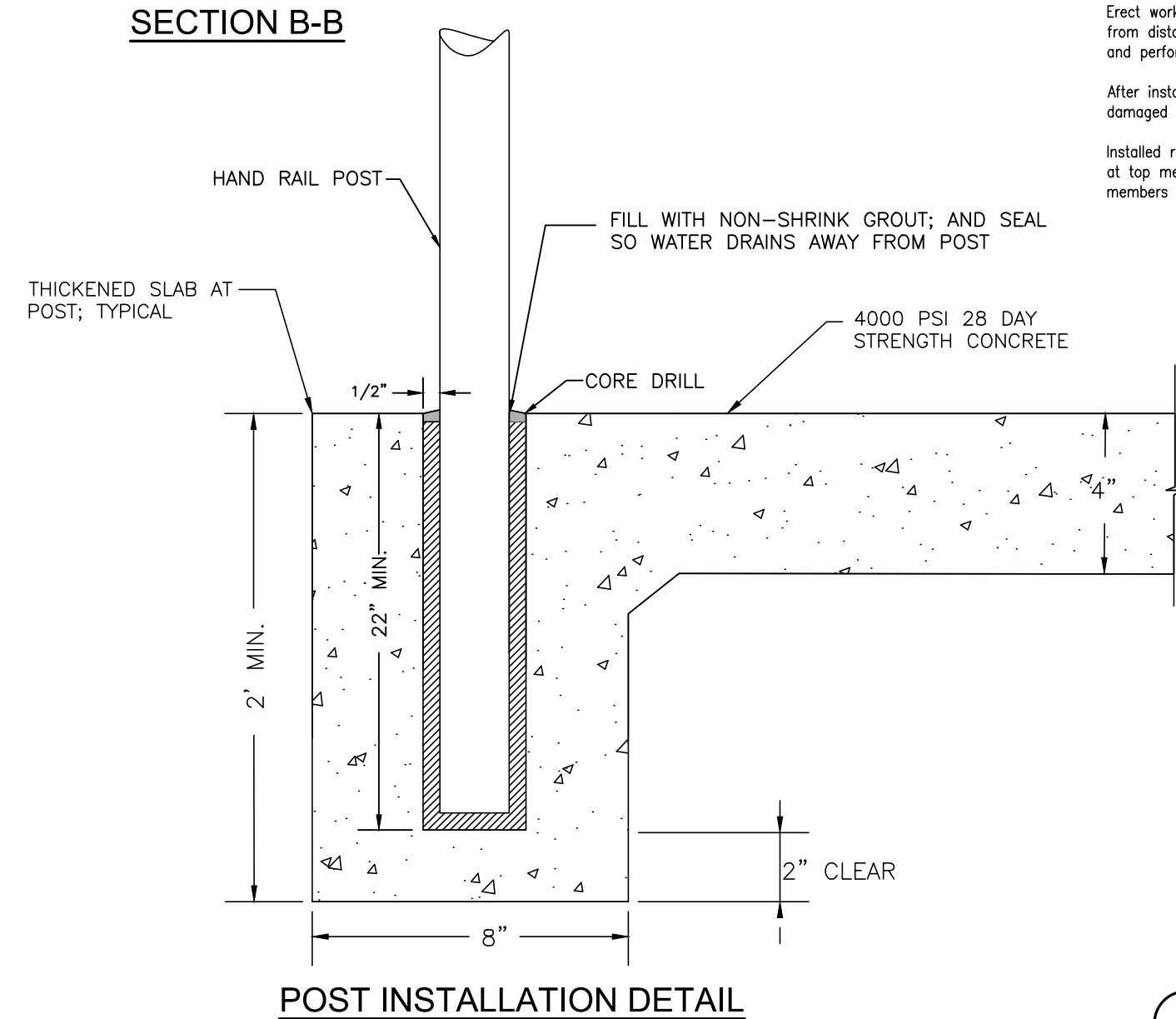

POST INSTALLATION DETAIL

GENERAL NOTES:

- Supply components required for proper anchorage of handrail.
- A. Grout: Core drill & set in concrete
- B. Expansion Anchors: Type and size to fit application
- Verify all dimensions and exist. conditions before beginning work.
- Fabricate bends smooth and wrinkle free. "Tig" weld components together. Grind welds smooth and finish to match.
- Fit and shop assembly in largest practical sections for delivery to site and installation. Perform field welding in accordance with AWS D1.1.
- Erect work square, level, accurate to sizes and free from distortion or defects detrimental to appearance and performance.
- After installation, touch up field welds, scratched or damaged surfaces to match specified finish.
- Installed railings to resist lateral forces of 200 lbs. at top member, without permanent set or damage to members or anchors.

CONCRETE STAIRS WITH CHEEK WALL DETAILS NOT TO SCALE

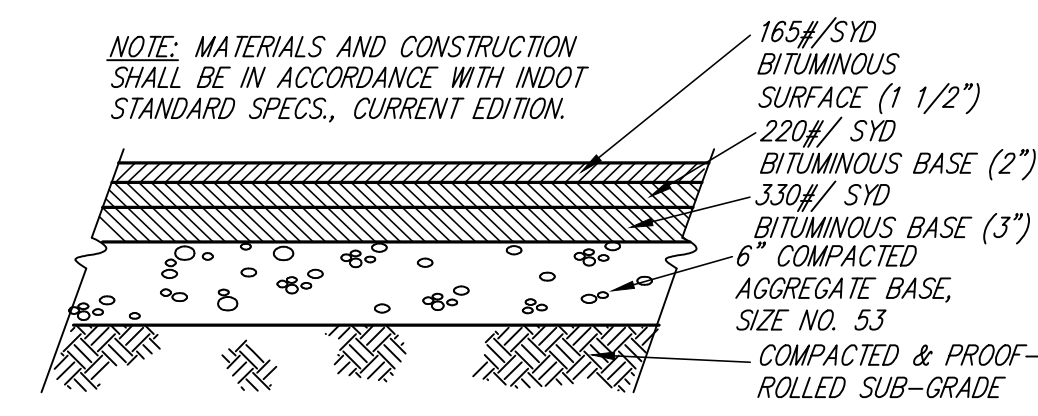

BITUMINOUS PAVING DETAIL NOT TO SCALE

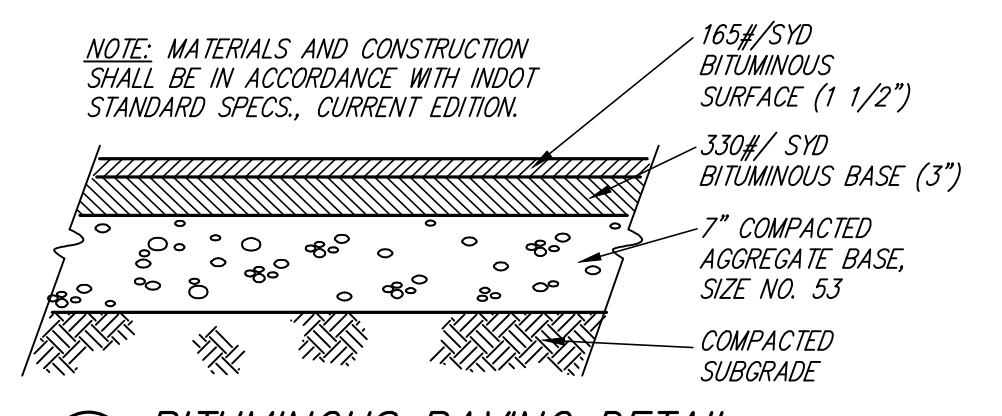

BITUMINOUS PAVING DETAIL NOT TO SCALE

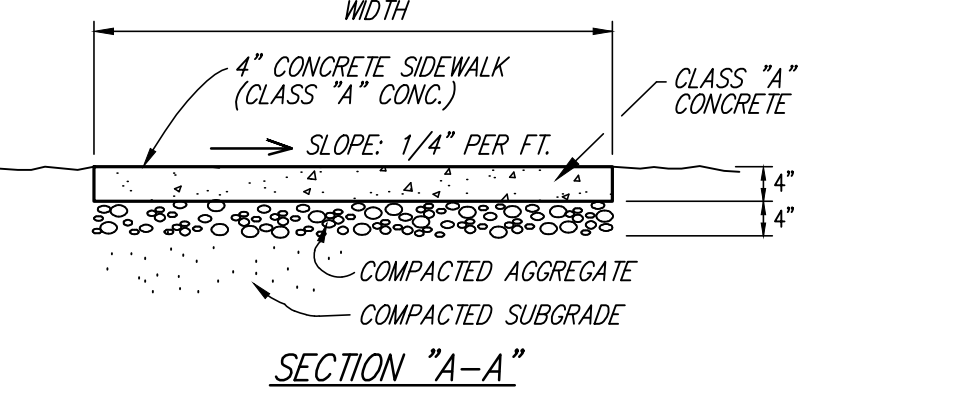

CONCRETE SIDEWALK DETAIL NOT TO SCALE

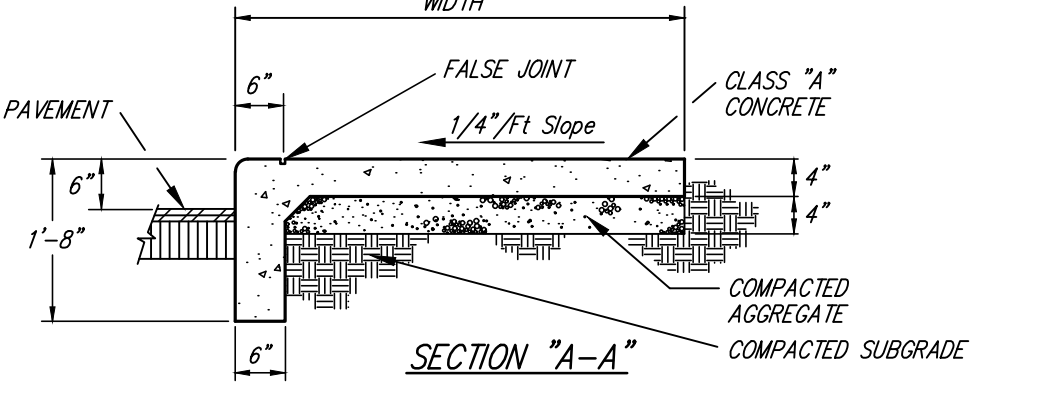

MONOLITHIC CONCRETE CURB AND SIDEWALK NOT TO SCALE

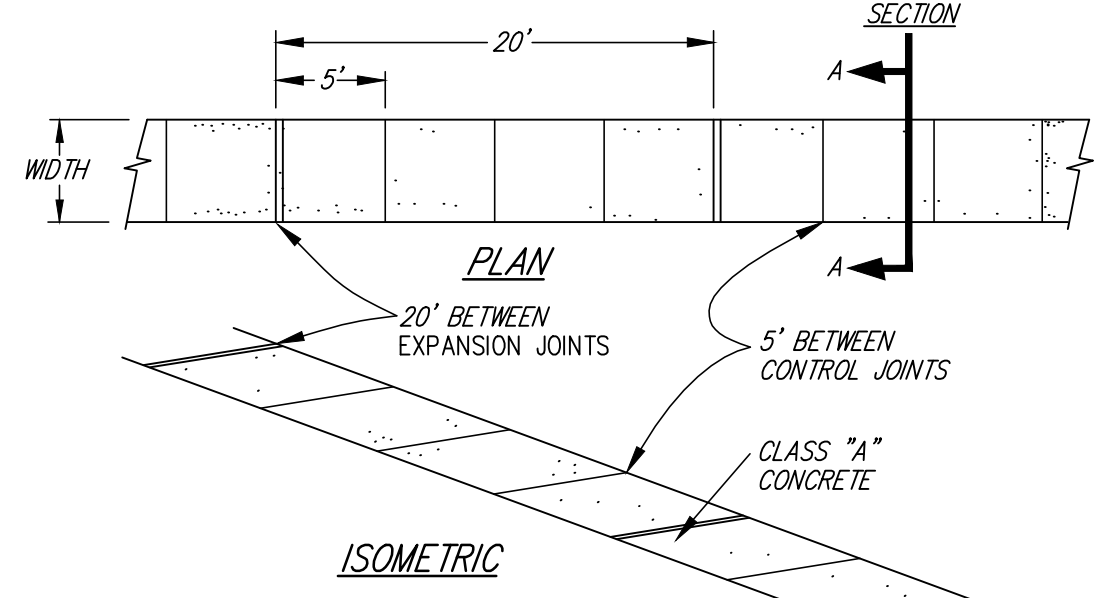

CONCRETE SIDEWALK DETAIL NOT TO SCALE

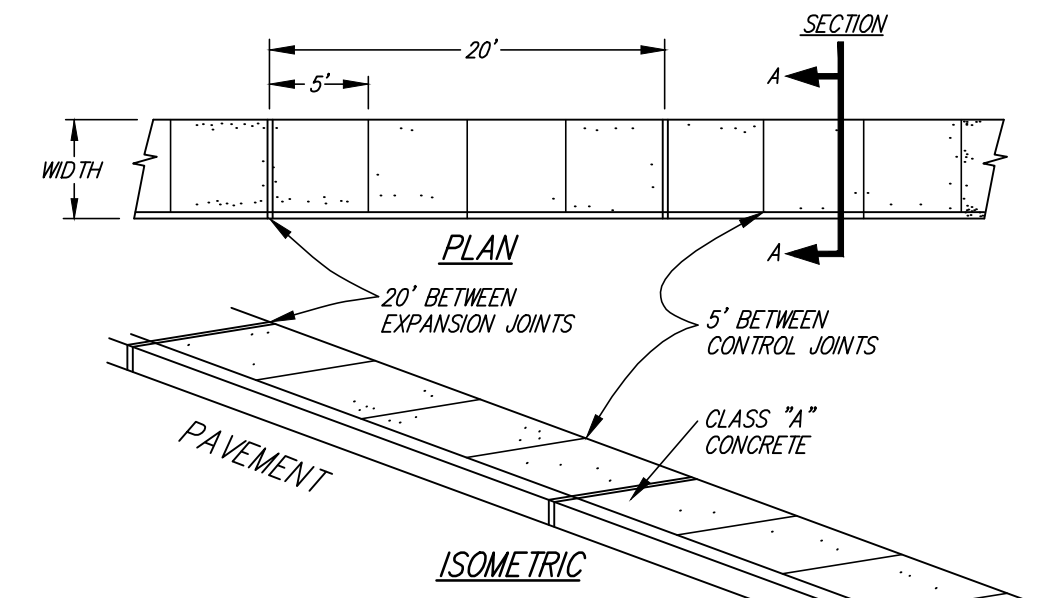

MONOLITHIC CONCRETE CURB AND SIDEWALK NOT TO SCALE

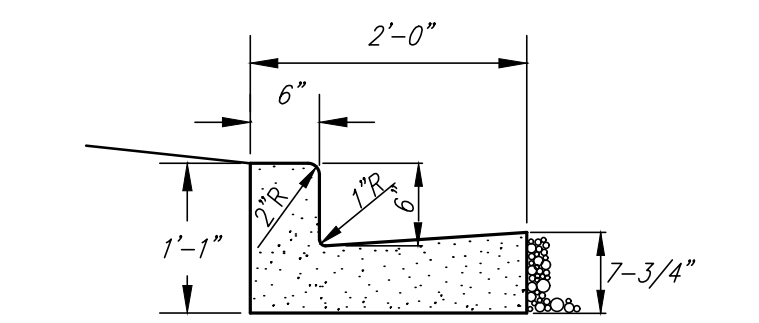

CONCRETE CURB AND GUTTER NOT TO SCALE

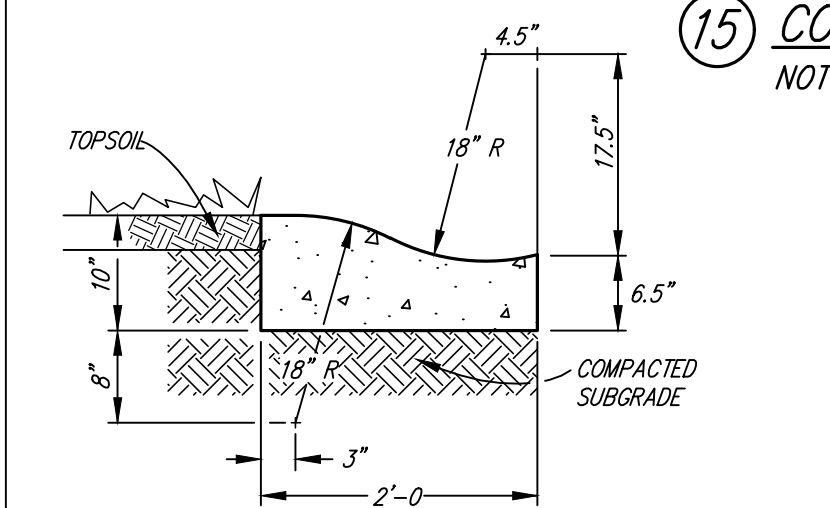

CONCRETE ROLL CURB AND GUTTER NOT TO SCALE

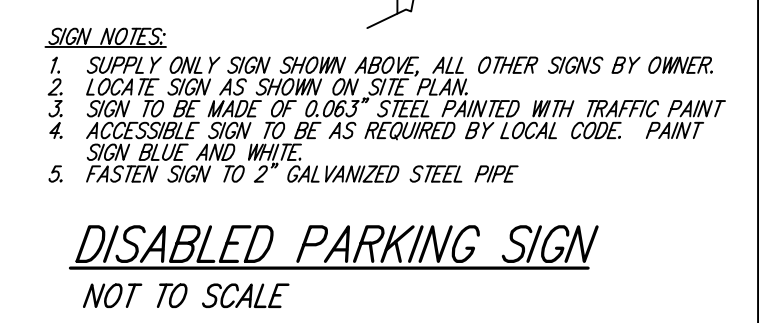
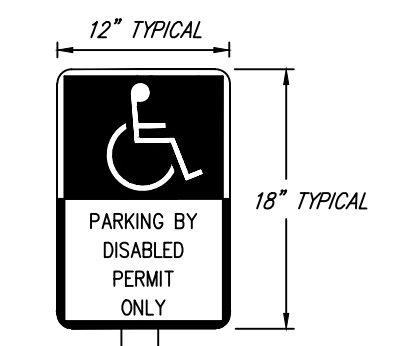

DISABLED PARKING DETAIL NOT TO SCALE

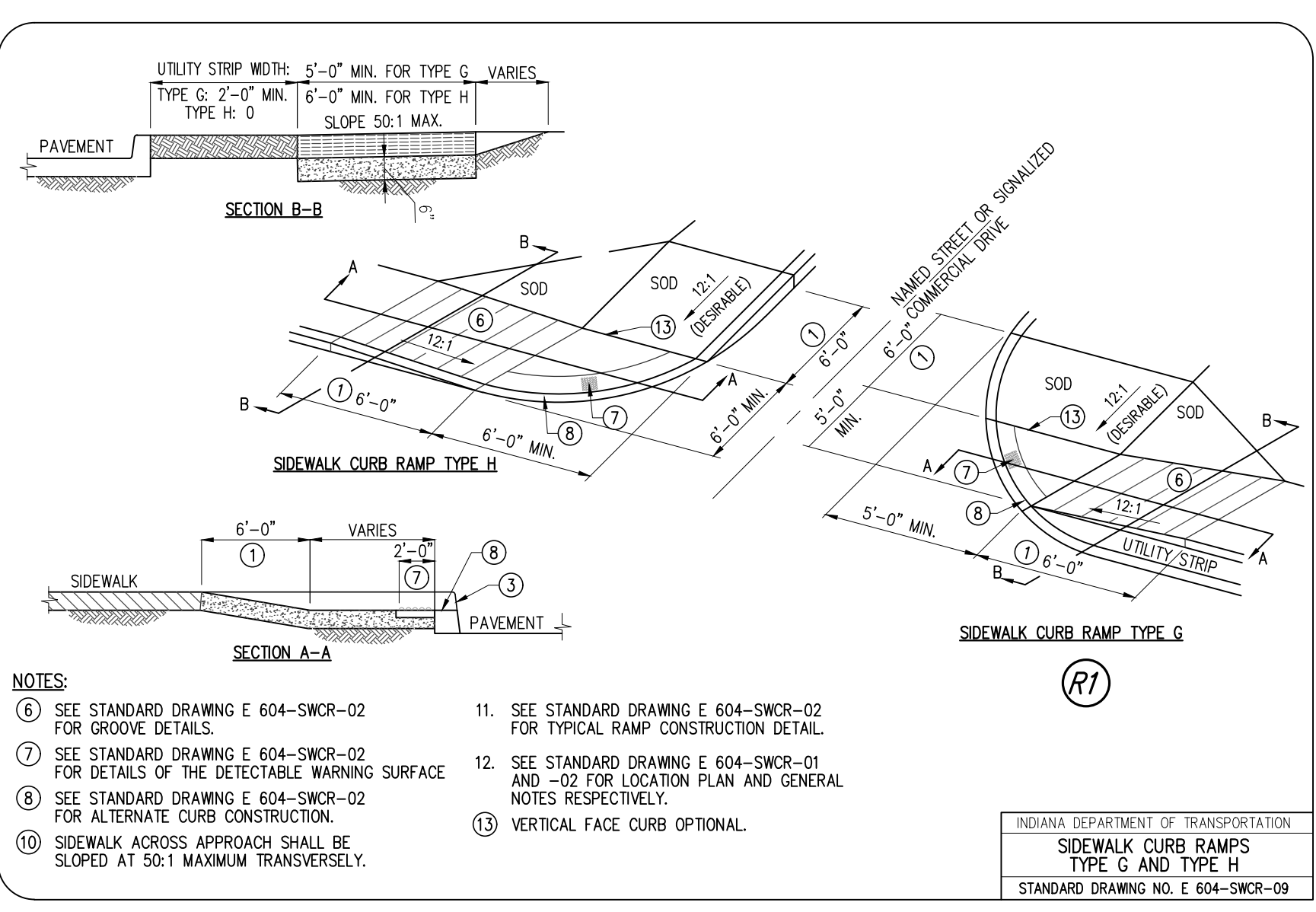
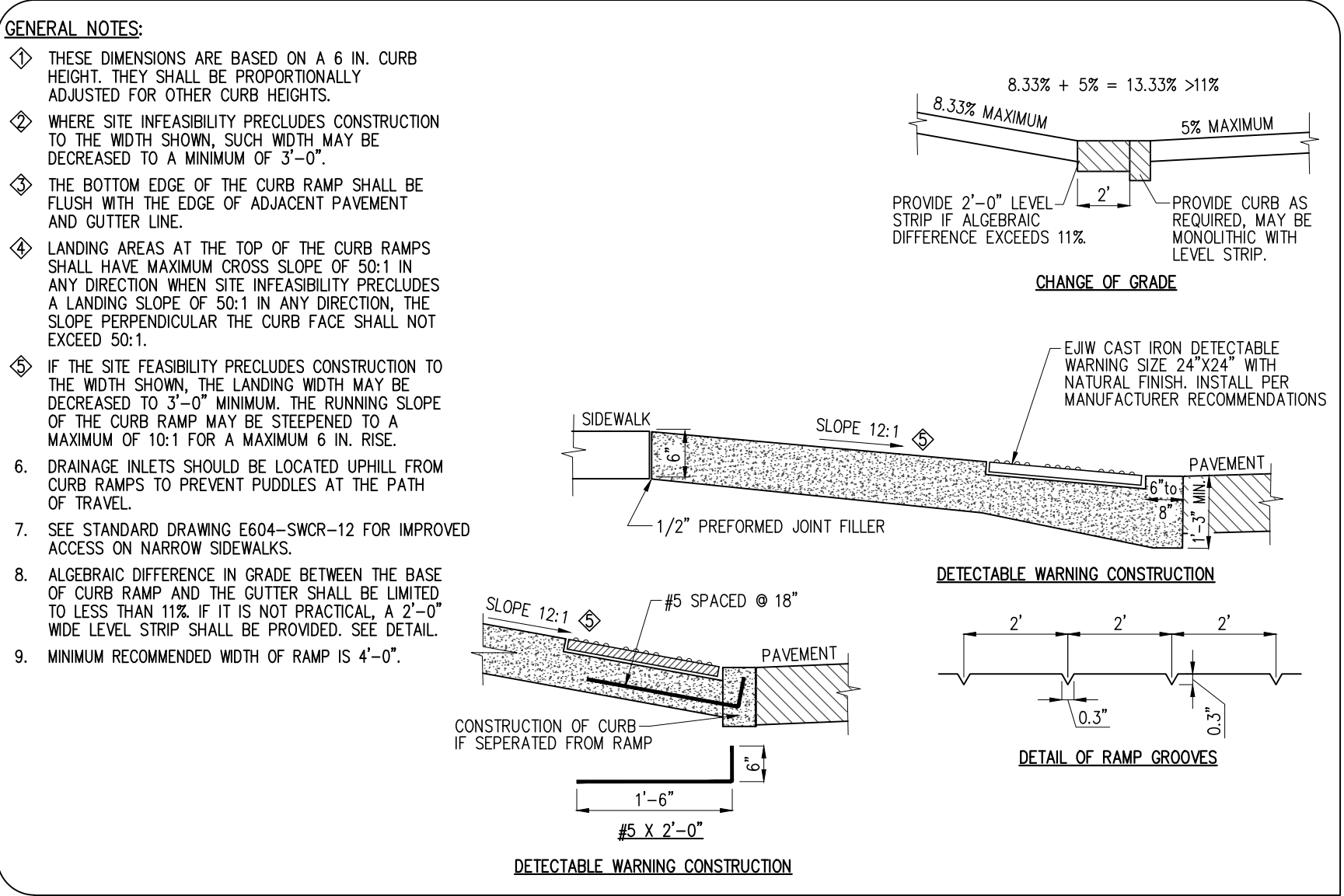

INDIANA DEPARTMENT OF TRANSPORTATION
SIDEWALK CURB RAMP TYPE G AND TYPE H
STANDARD DRAWING NO. E 604-SWCR-09

NOTES:
 (6) SEE STANDARD DRAWING E 604-SWCR-02 FOR GROOVE DETAILS
 (7) SEE STANDARD DRAWING E 604-SWCR-02 FOR DETAILS OF THE DETECTABLE WARNING SURFACE
 (8) SEE STANDARD DRAWING E 604-SWCR-02 FOR ALTERNATE CURB CONSTRUCTION.
 (10) SIDEWALK ACROSS APPROACH SHALL BE SLOPED AT 50:1 MAXIMUM TRANSVERSELY.
 (11) SEE STANDARD DRAWING E 604-SWCR-02 FOR TYPICAL RAMP CONSTRUCTION DETAIL.
 (12) SEE STANDARD DRAWING E 604-SWCR-01 AND -02 FOR LOCATION PLAN AND GENERAL NOTES RESPECTIVELY.
 (13) VERTICAL FACE CURB OPTIONAL.

NOTE: CONTRACTOR SHALL VERIFY ALL UTILITY LOCATIONS & DEPTHS AND NOTIFY ENGINEER OF ANY INACCURACIES IN LOCATION OR ELEVATION OR ANY CONFLICTS PRIOR TO & AFTER ANY EXCAVATION. NO PAYMENT SHALL BE MADE TO CONTRACTOR FOR UTILITY DESTRUCTION OR UNDERGROUND CHANGES REQUIRED DUE TO CONFLICTING ELEVATIONS.

revisions:

ARCHITECTURE
CIVIL ENGINEERING
PLANNING

BYNUM FANTO & ASSOCIATES, INC.
528 north walnut street
Bloomington, Indiana
(812) 332-2990 (Fax)
(812) 332-8030

certified by:

Proposed:
HIGHLANDS SUBDIVISION PARCEL "E"
3201 S. Wickens Street
Bloomington Indiana

title: MISCELLANEOUS SITE DETAILS

designed by: DJB
drawn by: JR
checked by: JSF
sheet no: C501
project no.: 400593