

NEW RICHLAND 2 INC.
 INST. NO. 2010017286
 USE: VACANT
 PUD

PI STATION=4+31.51
 NORTHING=1414920.4275
 EASTING=3103557.7175
 I=00°24'27"
 T=313.70
 L=615.62
 R=1300.00
 Δ=02°07'58"

PI STATION=1+08.91
 NORTHING=1414577.5521
 EASTING=3103548.5807
 I=00°24'27"
 T=8.91
 L=17.82'
 R=1300.00
 Δ=000°47'07"

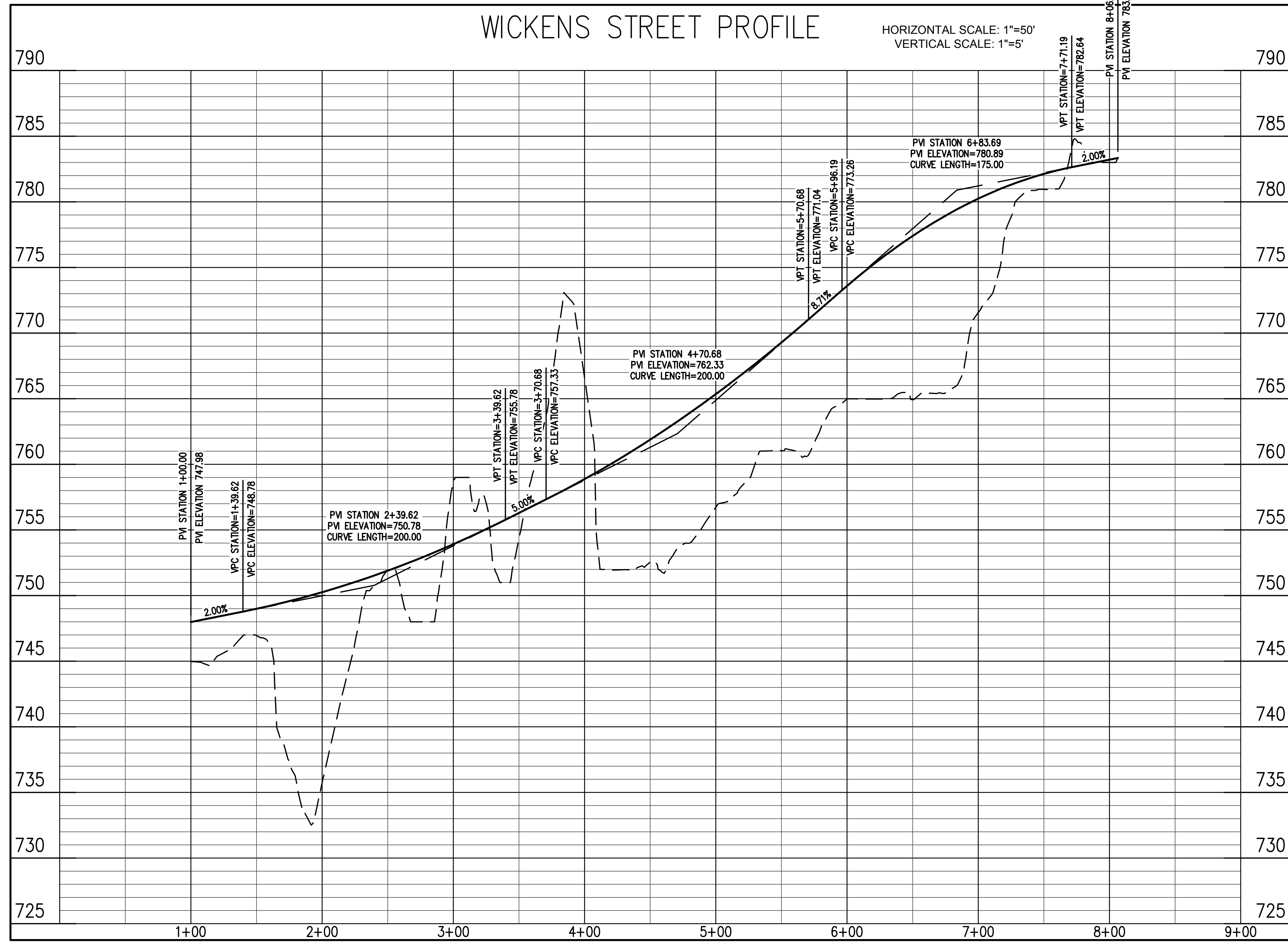
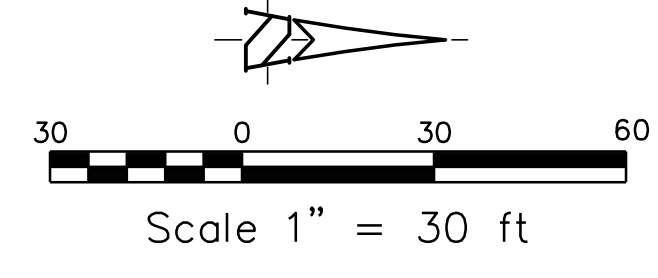

revisions:

ARCHITECTURE
 CIVIL ENGINEERING
 PLANNING

BFB
 BYNUM FANTO & ASSOCIATES, INC.
 528 north walnut street
 (812) 332-8030

bloomington, indiana
 (812) 339-2990 (Fax)

certified by:

proposed:
HIGHLANDS SUBDIVISION PARCEL "E"
 3201 S. Wickens Street
 Bloomington, Indiana

title: WICKENS STREET
 PLAN & PROFILE

designed by: **DJB**
 drawn by: **DJB**
 checked by: **JSF**
 sheet no: **C302**
 project no.: **401808**